

Lot 11
Domestic Map No. 4
Kaunamano Hamakua Hawaii

Grant No. 4073
TO *Antoine Furtado*
Date.

Homestead Map 4.
Hamakua, Hawaii.

Lot 11, in Kaunamano.

Beginning at the Northeast corner of Lot 9 and running by true bearings as follows:

- 1 N 77° 22' W 272 feet along Lot 9.
- 2 N 12° 35' E 760 feet along the middle of the gulch dividing this from Lot 6.
- 3 N 10° 12' W 490 feet along the same, dividing this from Lot 7.
4. N 2° 0' W 510 feet along the same;
- 5 S 81° 0' E 432 feet along S. 6 A 11051, Cus
- 6 S 14° 12' W 653 feet along road 30 feet wide;
- 7 S 14° 50' E 398 feet along the same;
- 8 S 12° 35' W 718 feet along the same to the initial point and containing an area of $11 \frac{60}{100}$ Acres.

From lines of Homestead Map 4.

March 26, 1896. S. M. Kanakauy,
Asst. on Govt Survey.

L.C.A. 11051

02

L.C.A. 12057

Maliu

7

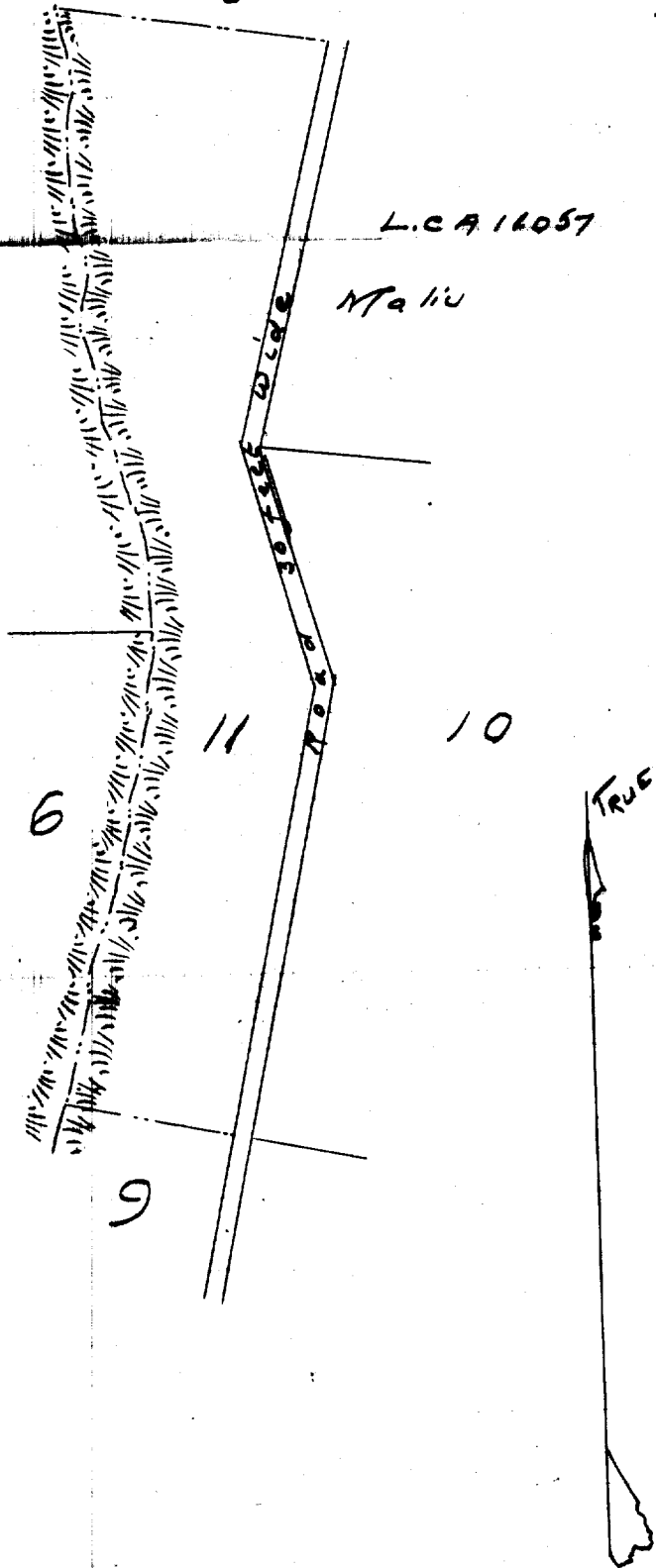

Scale 300 feet = 1 inch