

Lot 8
Oahuwai Govt. Lots
Hilo, Hawaii
Grant 4801
To
Jose Gomes Lerras

File in Carton 125.

PONAHAWAI, HILO, HAWAII, GOV'T. LOTS.

LOT #8.

Notes of Survey:-

Beginning at South angle of Lot #5, at pile of stones over the figures $\frac{5}{8}/\frac{6}{7}$ cut into rock by road, the coords. of which ref. to Govt. Survey Trig. Sta. "Halai" are 6840.8 ft South and 7168.9 ft West, as shown on Govt. Survey Reg. Map No. 2312, and running by true bearings ;

- 1.- S. $34^{\circ} 29'$ W. 486 ft. along road and lot #7.
- 2.- S. $60^{\circ} 37'$ W. 893 ft. along road and lot #7 to pile of stones over the figures $7\frac{9}{8}$ cut into rock by road at South angle.
- 3.- N. $38^{\circ} 15'$ W. 2985 ft. to West angle following along boundary lot #9 to pile of stones marked $\frac{8}{9}$
- 4.- N. $79^{\circ} 30'$ E. 1518 ft. to North angle, the line following boundary of Punahoa 1st. Cert #23 to pile of stones at Puu Eke.
- 5.- S. $38^{\circ} 22'$ E. 2270 ft. along lot #5 to point of beginning.

Containing 82.8 acres. Reserving however therefrom a right of way 20 ft. wide along South boundary this lot, adjacent to lot #7.

A.B.Loebenstein. Surveyor Bureau Public Lands.

Hilo, Jan. 26th. 1896.

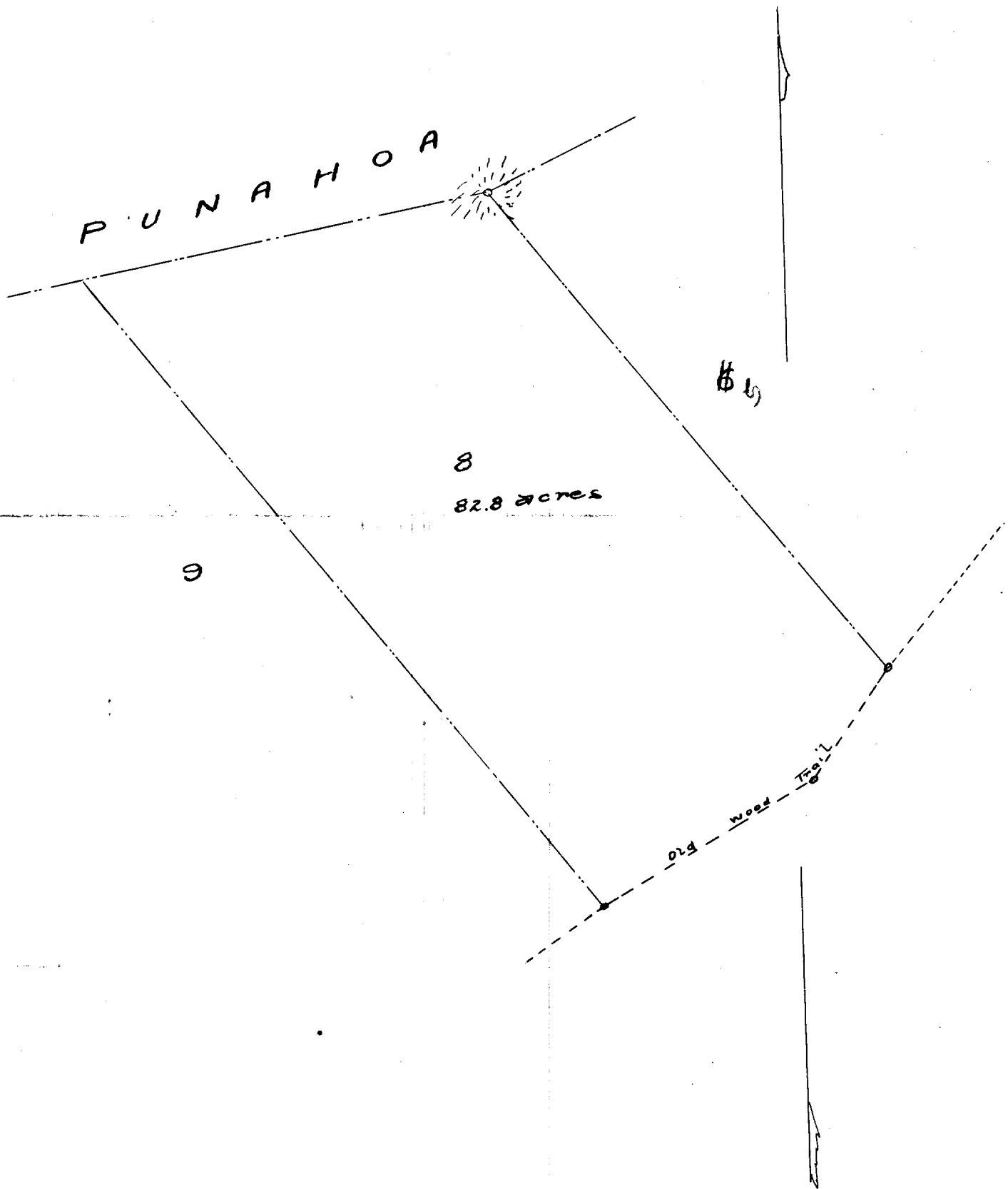

Scale 500ft = 1 in

Pohowai, Hilo, Hawaii, Plot Lots

Lot # 8

— Notes of Survey —

Re-furnished Land Office Mar 30/04.



File in Carton 125.

Pouakawai, Hilo, Hawaii, Gov't Lots.
 Lot # 8

Notes of Survey

Beginning at South angle of lot # 5 at pile of stones over
~~the road at which reference is made to Govt. Survey Trig. Sta. "Hahaione" are 6845 ft. South of 1165.9 ft. West~~
 as shown on Govt. Survey Registered Map No. 2312.
 the figures $\frac{5}{6}$ cut into rock by road, the boundary runs by true bearings

- 1 - S 34° 25' W - 486 ft. along road and lot # 7
- 2 - S 60° 37' W - 893 to pile of stones over the figures
 $\frac{7}{8}$ cut into rock by road at South angle
- 3 - N 38° 15' W - 2985 . . . to West angle, following along boundary lot # 9
 to pile of stones marked $\frac{8}{9}$
- 4 - N 79° 50' E - 1578 . . . to North angle, the line following boundary of
 Punchon 1st lot # 23 to pile of stones at
 Punu Cke
- 5 - S 38° 22' E - 2270 . . . along lot # 5 to point of beginning.

Containing 82.8 acres. Reserving however therefrom a right of way
 20 ft wide, along South boundary this lot, adjacent to lot # 7

A.B. Lutkenstein Surveyor Bureau Public Lands

Hilo January 27 - 1896

N. S. E. W. Coords.
 . 2620.8 - 2619.1 - 2901.6 - 2900.6 56840.8 W 7168.9

J.H.S. 5/14/12.