

Lot. 8.

Ninole & Waitou Kau.

Homestead Map. No. 17

Grant No. 4844

TO *Julio M. Machado*
Date.

Copy furnished Land Office
Sept 24/04

File in Carton 1.

Description of Lot 8,

Nihoa and Wailau, Kau. Homestead Map, 17

Beginning at a point on road marked + on rock which is 8124 feet North and 13890 feet West from Cook's Survey Station Pukehu and running as follows:

1. N $44^{\circ} 20'$ E true 30 feet along road.
- * 2. S $53^{\circ} 50'$ E " 1337 " " Lot 7
3. S $59^{\circ} 10'$ W " 1280 " " M. 2153 Kahaku.
- * 4. N $0^{\circ} 10'$ W " 1422 " " Lot 9 to initial point and containing an area of $18 \frac{38}{100}$ Acres.

Aug. 16th 1892,
Waiwai

* changed by O. L. Sorenson Sept. 23/04

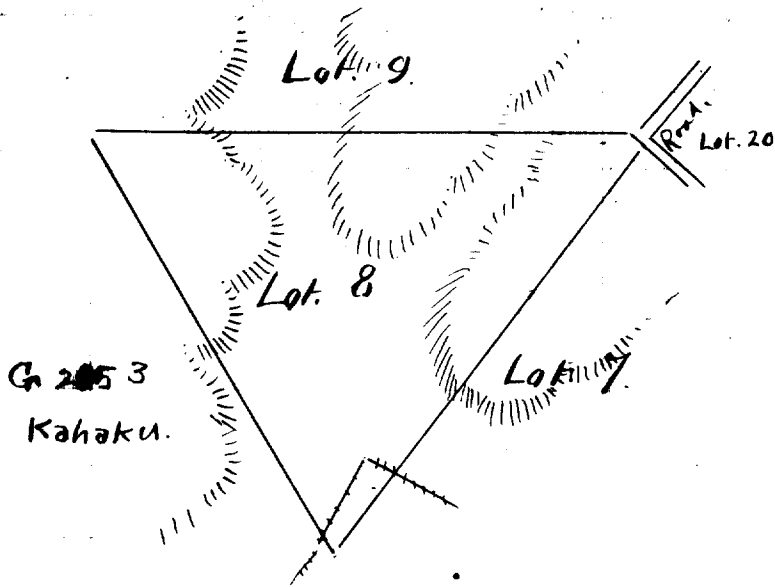

Scale. 500ft - 1 inch.

5. 100
12. 12
14. 100