

Lot 7
Homestead Map # 24
Hooluhua

Grant No.

TO

Date.

File in Carton 51.

Checked

Description of Lot 7, Homestead Map #24
Koolohua, Sp. 1 Kona, Molokai.

Beginning at a point on the makai side of a 25 foot road, said point being 440 feet South and 473 feet West of the point known as Keawe, and running;

- 1 S. 21° 54' E. True 2309 feet along Lot 8 to ^{shore,} Sea
- 2 S. 79° 35' W. " 332 feet along Sea shore,
- 3 N. 21° 54' W. " 2136 feet along Lot 6 to road,
- 4 N. 49° 35' E. " 340 feet along road to the Initial point.

Area 16.48 Acres

Walter E. Wall.

February, 1892

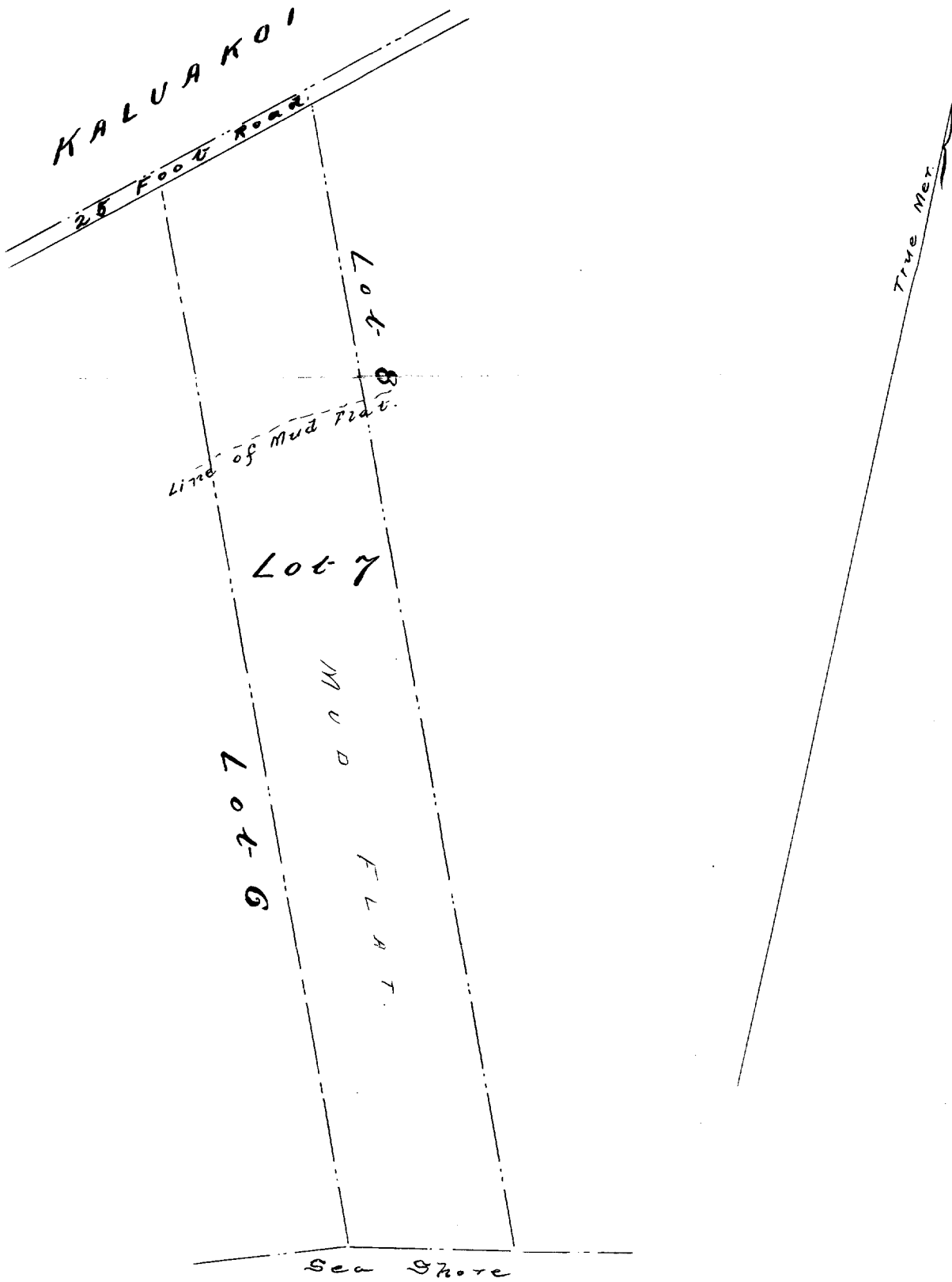

Scale 300 Feet to an Inch