

Lot. 12.  
Oleloana. Homesteads.  
Map 26.

Grant No.

TO

Date.

File in Carton 32

Description of Lot 12.  
 Okeleomona Homesteads Map, No.

Beginning at a point which is 15141 feet South and 1290 feet East from Cook Survey Station Waikakau and running as follows:—

1. West. true <sup>1015</sup> 1000 feet along Lot 11,
2. S. 17° 00' W. " ~~1060~~ <sup>1035</sup> " the mauka side of road being the boundary.
3. S. 76° 29' E. " 1000 " along Kaa parua,
4. N 16° 00' E " ~~1280~~ <sup>1150</sup> " " back to initial point and containing an area of  $24\frac{3}{10}$  Acres.

Aug. 5<sup>th</sup> 1892,  
 W. a. w. a. l.

Cancelled June 30 1915.

See Revised description to agree with re-location of upper limits of homesteads as by survey of Geo F Wright  
 See Reg. Map No. 2468.

R. D. King  
 Office Assistant, Survey Dept

	N	S	E	W	Area <u>new</u>
	12290	12472	13269	12000	24.5
<u>new</u>	11047.0	1105.3	1311.9	1312.6	

27

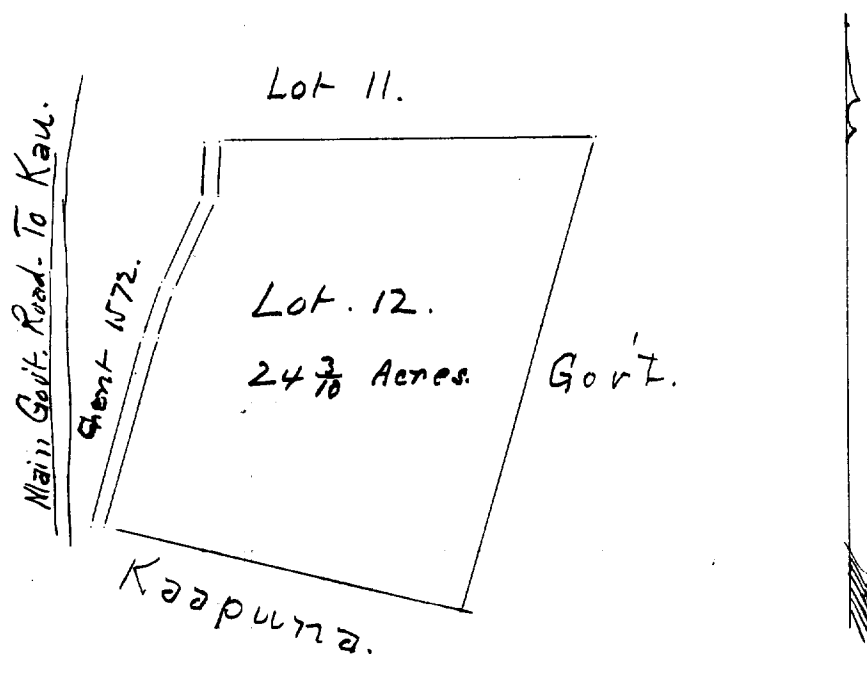

Scale 500ft = 1. inch -

Lot 12  
Oleloana Homestead  
South Kona Hawaii

Copy furnished Land Office  
June 30 1915

file in Carton 32

# Territory of Hawaii,

Office of the Government Survey.

Honolulu, T. H., June 30, 1915

Lot 12.

Olelomoana Homesteads,  
South Kona, Hawaii.

Beginning at the Northwest corner of this lot, the West corner of Lot 11 and on the East side of a 30 foot road the coordinates of said point of beginning being 5956.7 feet North and 4322.1 feet East of Government Survey Trig. Station "Kipahoe" as shown on Government Survey Registered Map No. 2468 and running by true azimuths:-

1.  $269^{\circ} 06'$  985.5 feet along Lot 11 to a + on set stone and ahu;
2.  $14^{\circ} 30'$  1300.0 feet along Government land to a + on set stone and ahu;
3.  $103^{\circ} 18' 30''$  996.6 feet along land of Kaapuna to a + on set stone and ahu at West side of a 30 foot road;
4. Thence along West side of 30 foot road to the point of beginning; direct azimuth and distance being  $197^{\circ} 00'$  1060.0 feet.

Area 26-28/100 Acres.

Compiled from surveys of W.A. Wall and Geo. F. Wright, by,

*Robt. O'Neal*

Assistant, Survey Department.

*MAN*

N	S	E	W	Area
1258.7	1258.6	1295.3	1295.3	26.3 A. (D.M.D.)

*L.A. Hatcher 7/7/15*